

8600 IS/ISH/ISJ/ISJH

Integra stop arm for regular, top jamb mount
with hold open (ISH, ISJH)

Installation instructions

08280071 – 01-2021

| EN |

dormakaba 

Table of contents

1	Technical specifications	3
1.1	Overview	3
1.2	Tools recommended	3
1.3	Handing the door	3
1.4	Surface closer components	4
2	Installation - regular mount	5
2.1	Securing surface closer and arm to door/frame	5
2.2	Securing main arm to closer	5
3	Instructions - top jamb mount	6
3.1	Securing surface closer and arm to door/frame	6
3.2	Securing main arm to closer	6
4	Adjustments	7
4.1	Adjust closing speeds: sweep, latch, backcheck, delayed action	7
4.2	Adjust optional hold open	7
4.3	Adjust spring force	8
5	Install covers	8

1 Technical specifications

1.1 Overview

 Caution: sex nuts are required for attachment of components to unreinforced doors and to wood or plastic faced composite type fire doors, unless an alternative method is identified in the individual door manufacturer's listings.

 Maximum door opening degree is 110°.

 Maximum 4-1/2" reveal on top jamb mounts for 110° degree openings.

 Know the swing of the door which is being installed prior to installation.

 Verify closer spring size prior to installation.

 Make sure door efficiently operates prior to installing closer.

1.2 Tools recommended

Table 1

Drill bits:	#3 phillips screwdriver
Metal: 7/32" drill bit; 1/4-20 tap	1/2" or 13mm box wrench
Wood: 5/32" bit	10" adjustable wrench
DPK: 1/8"	3/16" hex key
Sex nuts: 3/8"	5mm hex key

1.3 Handing the door

Fig.1

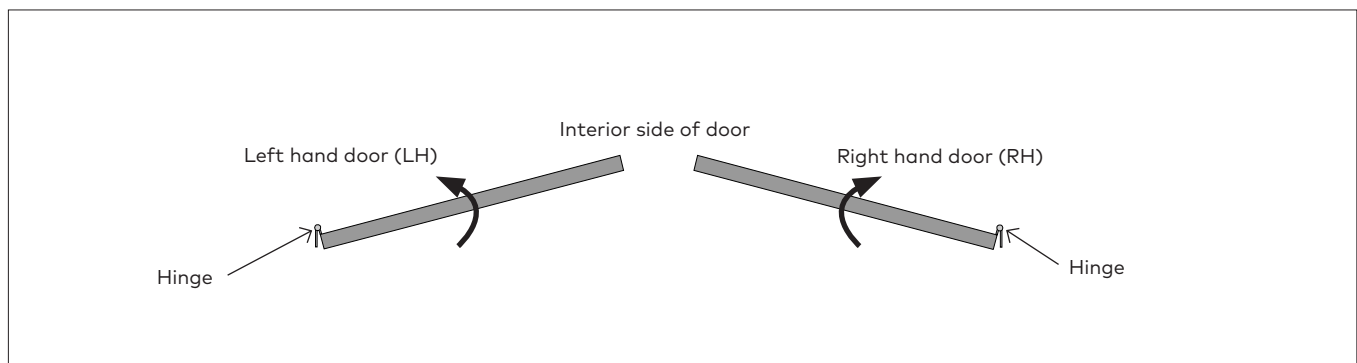

1.4 Surface closer components

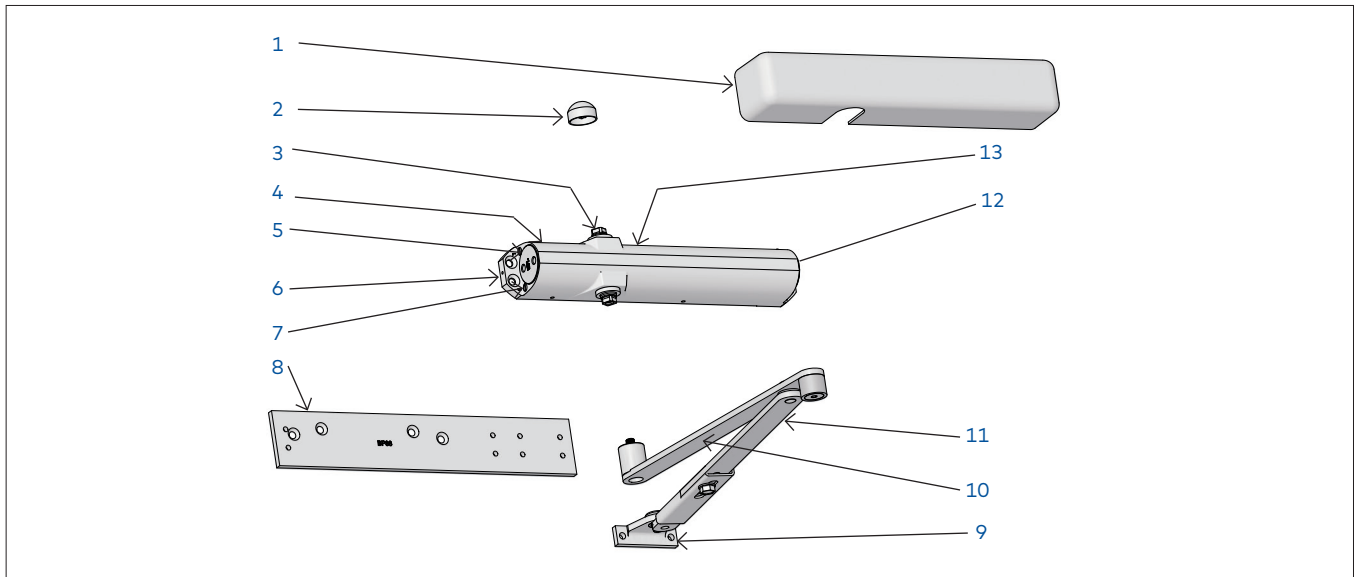

The surface closer is comprised of the following components.

- | | |
|------------------------------|-----------------------------------|
| 1. Cover | 7. Closing/sweep speed adjustment |
| 2. Dust cap | 8. Optional backplate |
| 3. Pinion screw | 9. Bar/shoe assembly |
| 4. Delayed action adjustment | 10. Main arm |
| 5. Latch speed adjustment | 11. Connecting arm |
| 6. Closer body | 12. Backcheck adjustment |
| | 13. Backcheck positioning |

2 Installation - regular mount

2.1 Securing surface closer and arm to door/frame

Fig.2

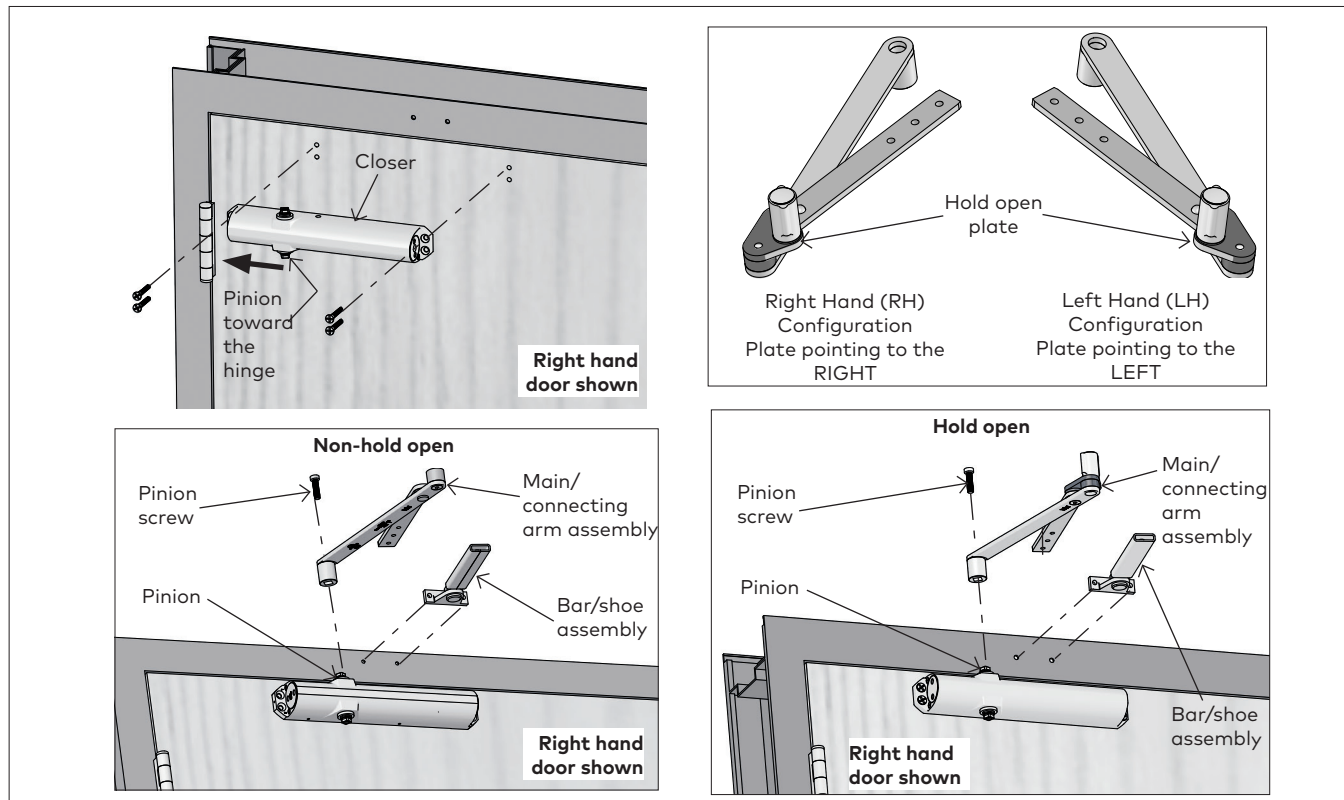

- 2.1.1 Secure closer body to door.
 - Use four 1-1/4" combo screws provided.
- 2.1.2 Secure the bar/shoe assembly to frame.
 - Use two 1/4-20 x 5/8" Phillips round head screws [#14 x 1-1/4" round head wood screws] provided.
- 2.1.3 Secure main arm to operator pinion.
 - Use a torque wrench (25 ft-lbs) and provided pinion screw [M8 x 30 socket head cap screw].

- NOTE: To change handing, disassemble hold open plate:**
- 2.1.4 Remove both screws from bottom of plate using a 3/16" hex key.
 - 2.1.5 Keeping all washers in place, flip plate over to orient as per image above.
 - 2.1.6 Re-secure plate with both screws.

2.2 Securing main arm to closer

Fig.3

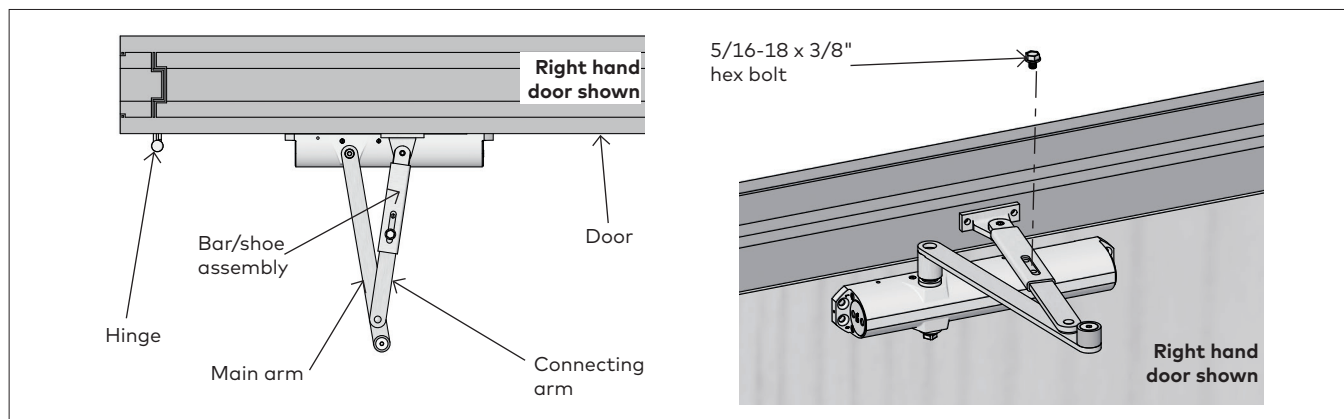

- 2.2.1 Slide end of connecting arm into end of damper assembly.
- 2.2.2 Secure connecting arm and damper assembly.
- 2.2.3 Use provided fastener [5/16-18 x 3/8 hex bolt].

3 Instructions - top jamb mount

3.1 Securing surface closer and arm to door/frame

Fig.4

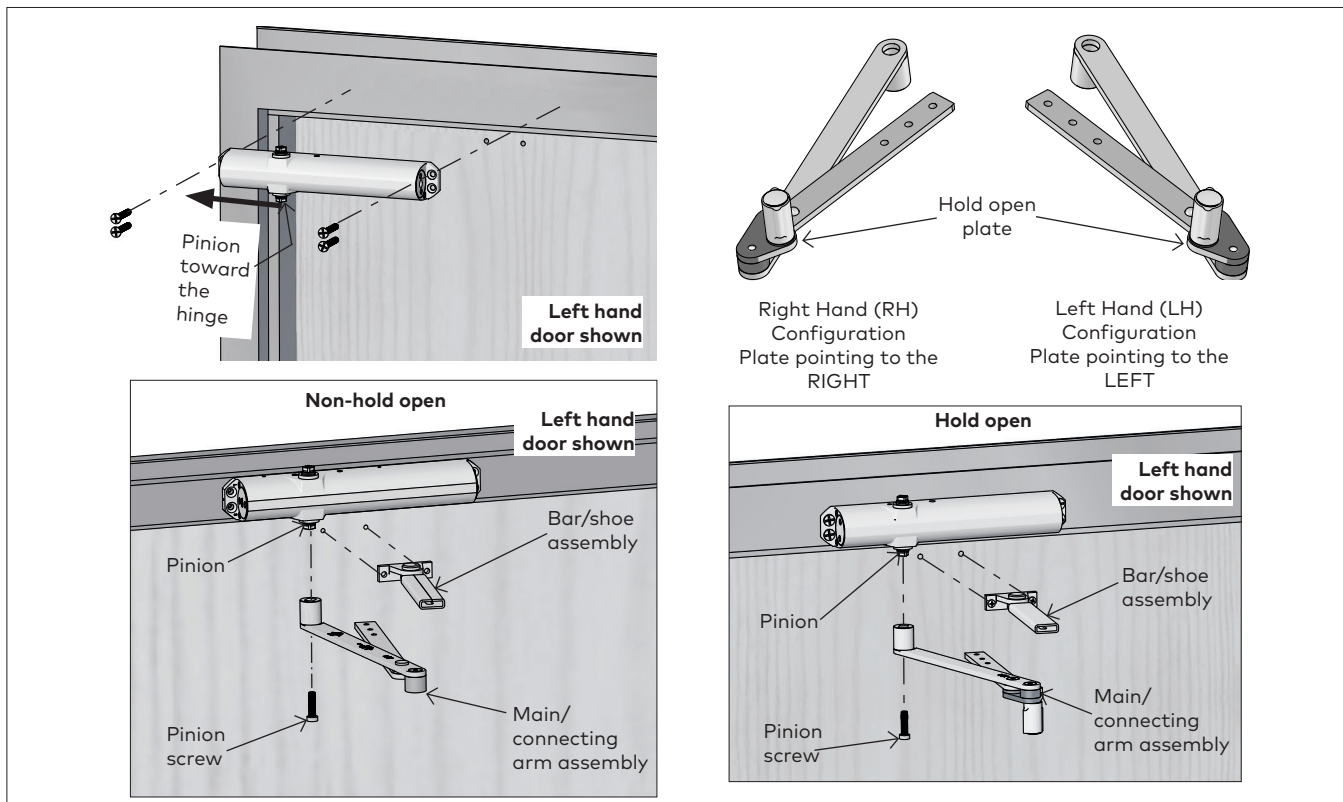

- 3.1.1 Secure closer body to frame.
 - Use four 1/4-20 x 5/8" Phillips flat head screws provided.
- 3.1.2 Secure bar/shoe assembly to mounting surface.
 - Use two 1/4-20 x 5/8" Phillips round head screws [#14 x 1-1/4" round head wood screws] provided.
- 3.1.3 Secure main arm to operator pinion.
 - Use a torque wrench (25 ft-lbs) and provided pinion screw [M8 x 30 socket head cap screw].

NOTE: To change handing, disassemble hold open plate:

- 3.1.4 Remove both screws from bottom of plate using a 4mm hex key.
- 3.1.5 Keeping all washers in place, flip plate over to orient as per image above.
- 3.1.6 Resecure plate with both screws.



3.2 Securing main arm to closer

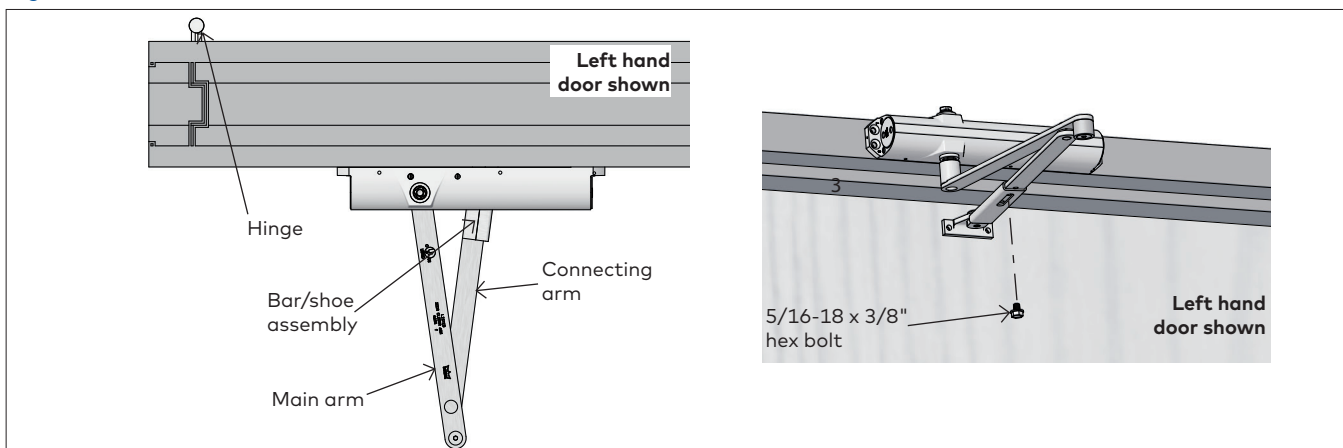

Fig.5



- 3.2.1 Slide end of connecting arm into end of damper assembly.
- 3.2.2 Secure connecting arm and bar/shoe assembly.
- 3.2.3 Use provided fastener [5/16-18 x 3/8 hex bolt].

4 Adjustments

-  Confirm closer spring size prior to making any closing speed adjustments.
-  Do not back valve heads out beyond closer casting.

-  Maximum opening angle is 110°.
-  Door should close in 3 to 6 seconds from 90°.
-  Do not close valves completely.

4.1 Adjust closing speeds: sweep, latch, backcheck, delayed action

Fig.6

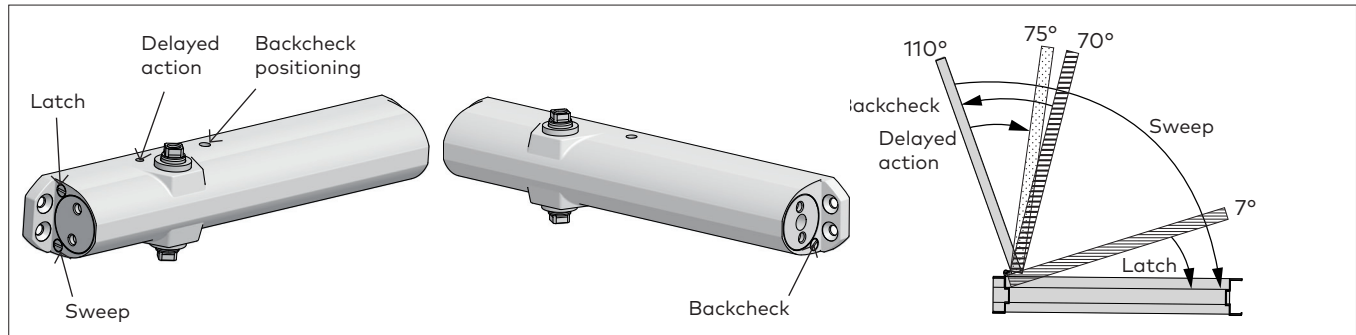

- 4.1.1 Adjust **sweep speed** for the area from 70° - 10°.
- Increase sweep speed: Turn valve counter-clockwise
 - Decrease sweep speed: Turn valve clockwise
- 4.1.2 Adjust **latch speed** from 10° - 0°.
- Increase latch speed: Turn valve counter-clockwise
 - Decrease latch speed: Turn valve clockwise
- 4.1.3 Adjust **backcheck** for the area from 110° - 70°.
- Increase resistance: Turn valve clockwise
 - Decrease resistance: Turn valve counter-clockwise.

- 4.1.4 Adjusting **backcheck positioning** will advance approximately 15° in the "ON" position. Shipped from factory fully "ON".
- Turn OFF: Rotate counter-clockwise
 - Turn ON: Rotate clockwise
- 4.1.5 Adjust **delayed action** for the area from 110° - 75°.
- Increase delay: Turn valve counter-clockwise
 - Decrease delay: Turn valve clockwise

4.2 Adjust optional hold open

Fig.7

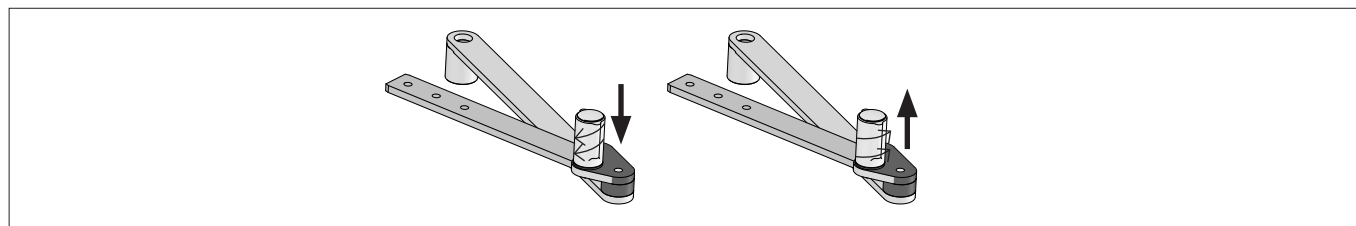

- 4.2.1 Enabling or disabling hold open.
- Twist hold open handle up or down to loosen or tighten, respectively, the hold open capacity.

- 4.2.2 Engaging or disengaging hold open.
- Engaging hold open: Push door open until hold open ball connects with detent in handle.
 - Disengaging hold open: Pull door to pop hold open ball out of detent.

4.3 Adjust spring force

Fig.8

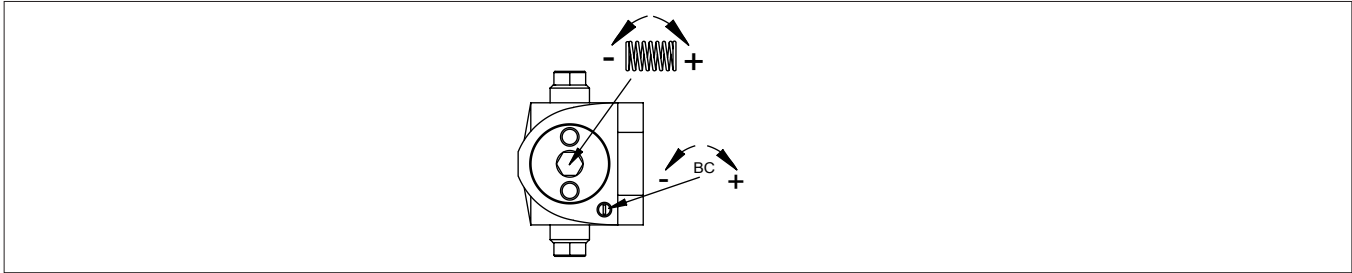

Regular and top jamb mounts				
	Closer size	Door width		Full turns
		Interior	Exterior	
	1	2'4"		
	2	2'10"	2'4"	-19
	3	3'2"	2'6"	-11
	4	4'	3'	0
	5	4'6"	3'6"	+5
	6	---	---	+13

5 Install covers

Fig.9

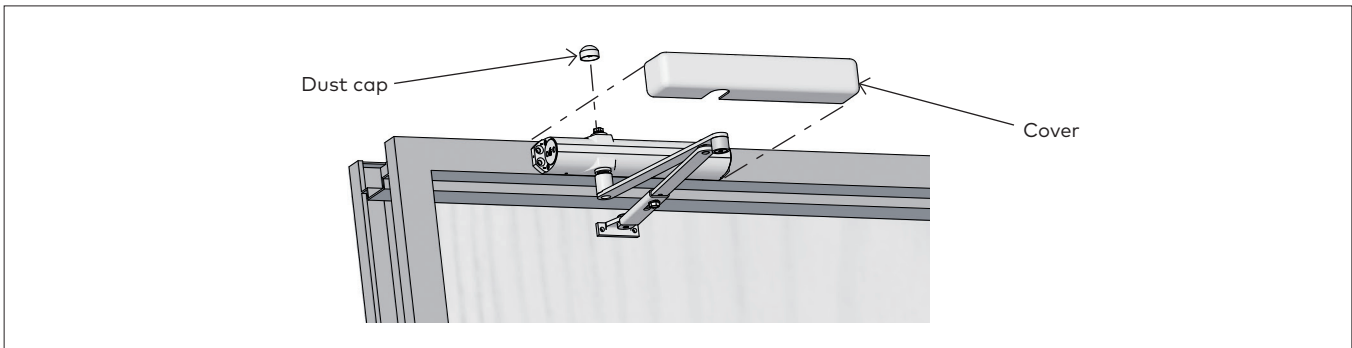

5.1.1 Snap cover over closer body.

5.1.2 Screw dust cap onto exposed pinion.

